



IN THE COMMISSIONERS COURT  
OF Sabine COUNTY, TEXAS

A PETITION BY PROPERTY OWNERS  
OF SABINE COUNTY,  
REQUESTING THE COMMISSIONERS COURT  
TO CLOSE ROAD TO THE PUBLIC

Pursuant to §§ 251.051, 251.052 and §251.058 of the Texas Transportation Code, the following parties, each being a property owner of land situated in Sabine County, Texas, hereby Petition the Commissioners Court of Sabine County, Texas, for the closure of a public road, having first provided twenty (20) day notice of their intent to apply by closure of the road in conformity with law. The proposed closure will not adversely affect the public interest, the road subject to closure having been abandoned and without maintenance for a period of time in excess of three years, and being enclosed within the property of those individuals seeking closure, and no other party requiring the road to access their own separate tracts of land.

The road, or portion thereof, to be closed, is described as follows:

The road to be closed is known as Sabine County Road Polley Lane West (county maintained), located approximately .044 down FM 330, extending a distance of approximately .259 to HWY 87 into the land owned by Dan Polley on both sides, Petitioner herein, and is described more fully as set forth herein:

|                       |                |                        |
|-----------------------|----------------|------------------------|
| Point of Beginning:   | A              | (See Attached Exhibit) |
| Point of Termination: | B              | (See Attached Exhibit) |
| Distance:             | 1,366.842 feet | (See Attached Exhibit) |

The parties signed below make application for the closure of said road by filing a petition with the Sabine County Commissioners Court on the 25<sup>th</sup> day of July, 2022, at a regular meeting of said Court scheduled for that date. Persons requiring further information should contact the Sabine County Judge, Hon. Daryl Melton, at Sabine County Courthouse, Hemphill, Texas 75948, or by calling at 409-787-3543. Interested parties should also plan to attend the Commissioners Court meeting on the date above.

1. Mark Bohannon  
Signature  
Printed Name: Mark Bohannon  
Address: 180 Boggy Creek Road  
Phone #: 936-572-2234 SAN AUGUSTINE TX

2. Shannon Bohannon  
Signature  
Printed Name: Shannon Bohannon  
Address: 180 Boggy Creek Rd.  
Phone #: (936) 288-2869 San Augustine, TX 75972

3. Susan Sheard  
Signature  
Printed Name: Susan Sheard  
Address: 440 Playcation Shrs. S.  
Phone #: 409-625-4125 Milam TX 75959

4. Raymond Sheard  
Signature  
Printed Name: Raymond Sheard  
Address: 440 Playcation Shrs. S.  
Phone #: 409-625-4125 Milam, TX. 75959

5. Dale Helm  
Signature  
Printed Name: DALE HELM  
Address: 645 CARTER FERRY RD  
Phone #: 409-625-4313

6. Millard E Smith  
Signature: MILLARD Smith  
Printed Name:  
Address: 2000 Reeves Rd  
Phone #: 409 625 1600

7. Ryan Svehla  
Signature: Ryan Svehla  
Printed Name: Ryan Svehla  
Address: 14300 HWY 87 N  
Phone #: 936-201-9075

8. Chanelle Svehla  
Signature  
Printed Name: Chanelle Svehla  
Address: 14300 HWY 87 N  
Phone #: 214 701 6991

Respectfully submitted,

Donald D. Bell

# Exhibit

## SABINE COUNTY APPRAISAL DISTRICT

[Home](#) [Return to Search](#) [Print](#)

[Property Year 2022](#) [Map/Gis](#)

Information Updated 6/16/2022

Property ID: R000058961 Geo ID: 21040-00030-10000-000000

< Previous Property **8 / 18** Next Property >

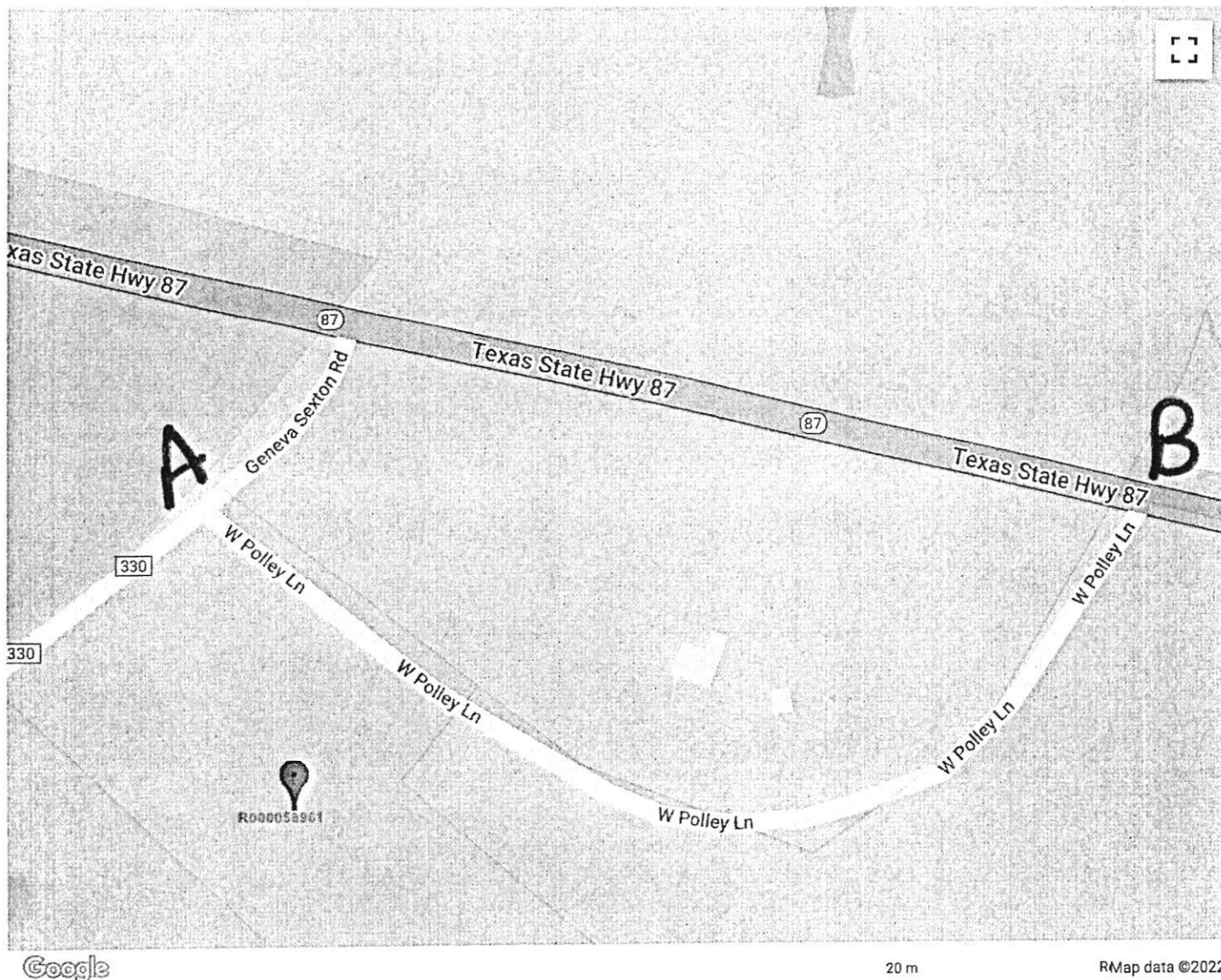

Southwest Data Solutions provides this information "as is" without warranty of any kind.  
Southwest Data Solutions is not responsible for any errors or omissions.

Petition to close: Polley Lane West .259 mile or 1366.842 feet

Vol 3-y Page 179